

STAINLESS STEEL TWO-PIECE, FULL PORT, DVGW

BV2 - 2 F D - 1/4" - 2" BSP - T1-2



Drinking water
NW-6102B00271



FEATURES

- Two-piece ball valve "screwed design"
- Full port design
- Blow out proof stem design
- Adjustable stem packing
- Female thread according to ISO 228-1
- Vent bore from DN25-DN50

MATERIALS

Body:	stainless steel 1.4408
Ball:	stainless steel 1.4408
Ball seal:	PTFE
Stem:	stainless steel 1.4401
Stem packing:	PTFE
Handle:	stainless steel with green plastic cover

TYPES

Type 1



Standard handle

Type 2



T-handle

WORKING TEMPERATURE

-20°C to max. +180°C (depending on working pressure) cold and hot water

SUITABLE FOR

Water, oil, compressed air, fuels, solvents, steam, aggressive mediums, food, beverages
Tube system for drinking water PN10

REMARKS

- Gland nut must be adjusted in intervals.
- Drinking water registered according to DIN EN 13828 and DVGW W 570.

STAINLESS STEEL TWO-PIECE, FULL PORT, DVGW

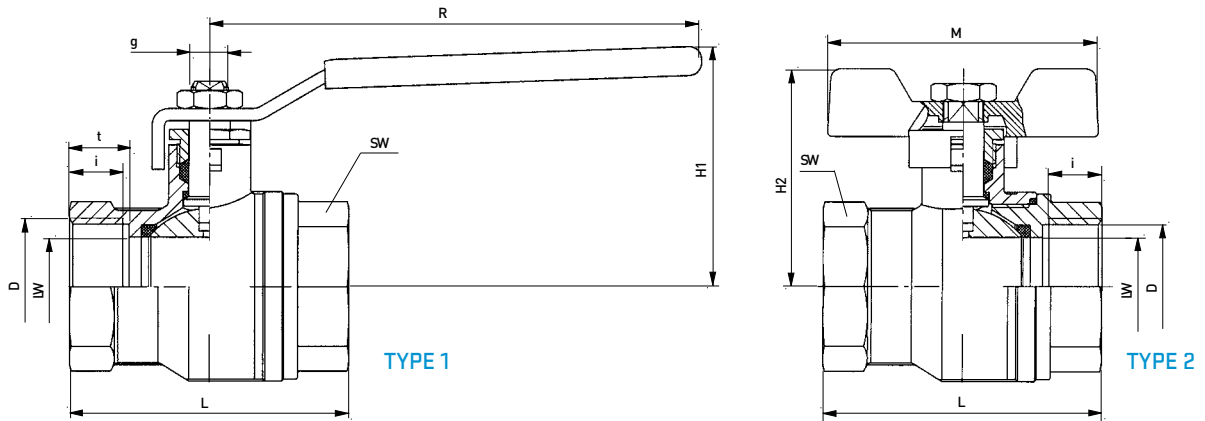

PRESSURE TEMPERATURE DIAGRAM

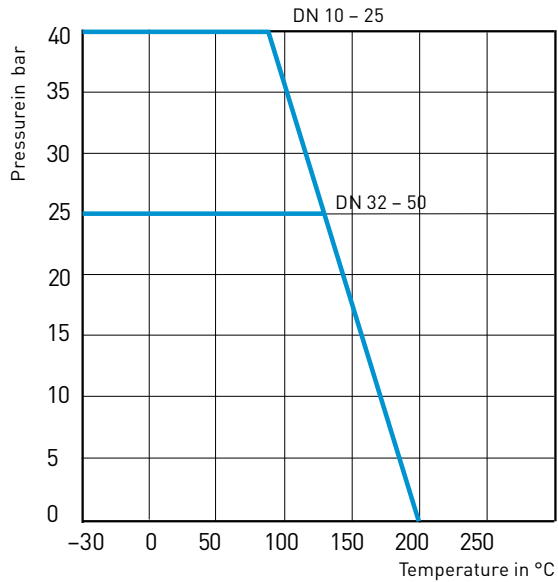

DIMENSIONS (MM)

DN	LW	PN bar	D ISO 228	i*	t	L ±2	g	H1	R	H2	M	SW	Weight (kg)	
6	9	40	G 1/4	8.5	10	40	1/4-20 UNC	40	82	40	50	20	hexa- gon	0.128
10	9	40	G 3/8	8.5	10	40	1/4-20 UNC	40	82	40	50	20		0.118
15	14	40	G 1/2	10	11.5	50	5/16-18 UNC	45	100	44.5	60	25	Octagon	0.184
20	19	40	G 3/4	11	12.5	60	5/16-18 UNC	49	100	48.5	60	31		0.308
25	24	40	G 1	13	14.5	68	3/8-16 UNC	57	120	53	66	38		0.458
32	30	25	G 1 1/4	14	15.5	80	3/8-16 UNC	62	120	58.4	66	48		0.738
40	38	25	G 1 1/2	16	17.5	94	M12x1.25	80	160	-	-	54		1.235
50	47	25	G 2	17	18.5	106	M12x1.25	87	160	-	-	66	1.970	

*i = useable length of thread