

BRASS

TWO-PIECE, FULL PORT, 25 BAR

BV1 - 2 F - 1/4" - 2" BSP - T1-4



DESIGN FEATURES

- Full port design
- Marking according to EN 19
- Blow out proof stem design with double O-ring sealing
- Strong stem design with steel handle
- Strength of valve body and cap according to EN 331

WORKING TEMPERATURE

-20°C to +170°C
(depending on working pressure)

SUITABLE FOR

Water, oils, compressed air, fuels, solvents etc.

MATERIALS

Body: hot pressed brass, nickel plated
Ball: brass chrome plated
Ball seal: PTFE
Stem seal: Viton
Handle: steel, zinc coated
with red plastic cover

TYPES

Type 1 & 2

Type 3 & 4



Standard handle



T-handle

BRASS

TWO-PIECE, FULL PORT

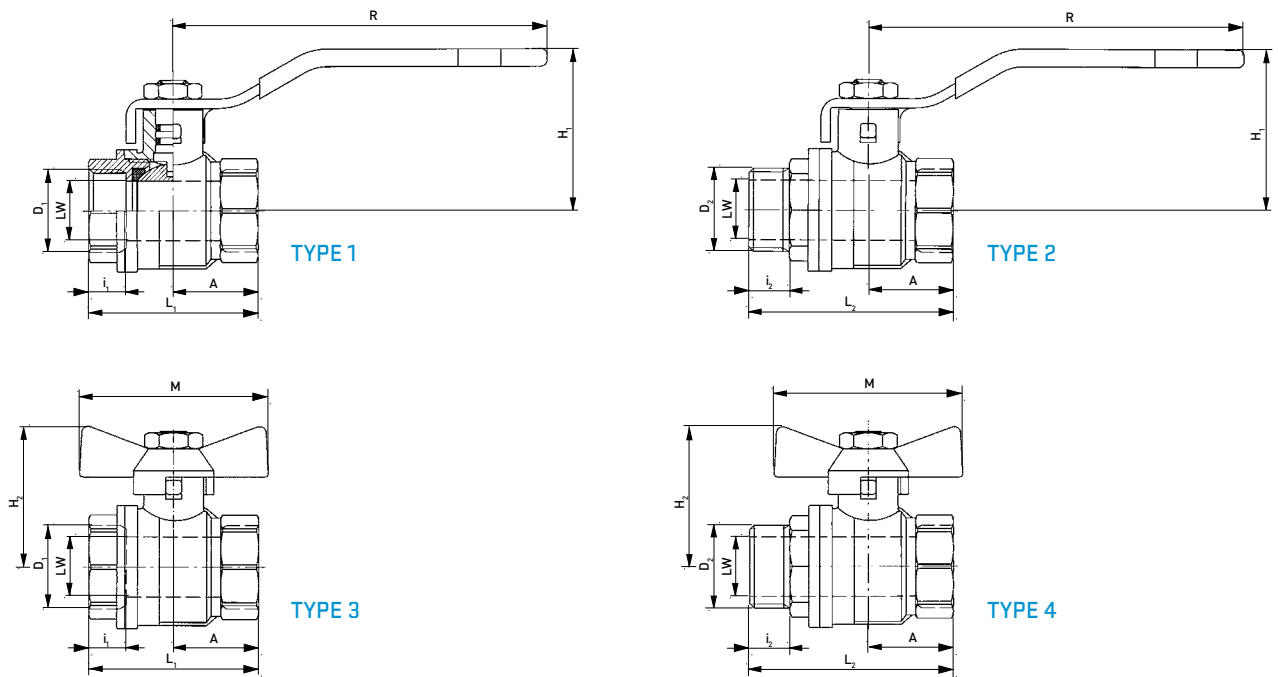

PRESSURE TEMPERATURE DIAGRAM

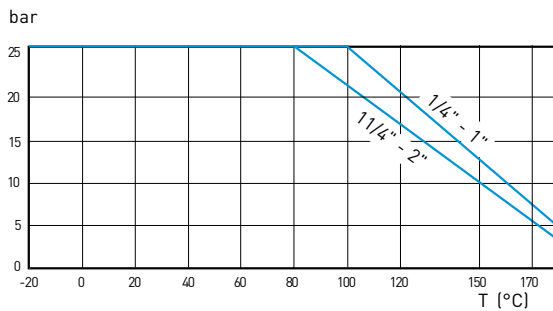

DIMENSIONS (MM)

| DN | LW | PN bar | D1 DIN ISO 228 | D2 ISO 7/1 | L1 ±2 | L2 ±2 | i1 | i2 | A | H1 | H2 | R | M | SW | Weight (kg) | | | |
|----|----|-----------|-------------------|---------------|----------|----------|------|------|------|------|------|-----|----|----|-------------|--------|--------|--------|
| | | | | | | | | | | | | | | | type 1 | type 2 | type 3 | type 4 |
| 6 | 9 | 25 | G ¼ | R ¼ | 41.5 | 50 | 9 | 10 | 20.3 | 37.5 | 33.5 | 82 | 50 | 20 | 0.140 | 0.145 | 0.120 | 0.130 |
| 10 | 10 | 25 | G ⅜ | R ⅜ | 41.5 | 50 | 9 | 10 | 20.3 | 37.5 | 33.5 | 82 | 50 | 20 | 0.120 | 0.135 | 0.104 | 0.120 |
| 15 | 14 | 25 | G ½ | R ½ | 51 | 59 | 11.5 | 12 | 24.5 | 43.5 | 39.5 | 100 | 50 | 25 | 0.220 | 0.235 | 0.192 | 0.210 |
| 20 | 19 | 25 | G ¾ | R ¾ | 54 | 65 | 12 | 13 | 27.0 | 50.0 | 44.5 | 120 | 60 | 31 | 0.320 | 0.345 | 0.275 | 0.308 |
| 25 | 24 | 25 | G 1 | R 1 | 67 | 78 | 13 | 16 | 33.5 | 53.5 | 48.0 | 120 | 60 | 38 | 0.495 | 0.550 | 0.366 | 0.485 |
| 32 | 30 | 25 | G 1¼ | R 1¼ | 77 | 87 | 13 | 16.5 | 38.5 | 70.0 | - | 165 | - | 48 | 0.775 | 0.830 | - | - |
| 40 | 38 | 25 | G 1½ | R 1½ | 90 | 97 | 15.5 | 16.5 | 46.5 | 75.0 | - | 165 | - | 54 | 1.035 | 1.125 | - | - |
| 50 | 48 | 25 | G 2 | R 2 | 106 | 114 | 17 | 18 | 53.0 | 82.0 | - | 165 | - | 66 | 1.570 | 1.680 | - | - |